

Cal. 3520.D

English
User's Manual

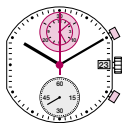

Description of the display and control buttons

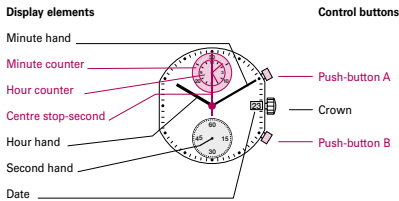

01

Setting the time

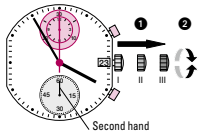

- 1 * Pull out the crown to position III (the watch stops).
- 2 Turn the crown until you reach the correct time 8:45.
- 3 * Push the crown back into position I.

Please note:
* In order to set the time to the exact second, 1 must be pulled out when the second hand is in position «60» (I). Once the hour and minute hands have been set, 3 must be pushed back into position I at the exact second.

02

Setting the date (quick mode)

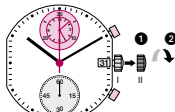

- 1 Pull out the crown to position II (the watch continues to run).
- 2 Turn the crown anticlockwise until the correct date [1] appears.
- 3 Push the crown back into position I.

Please note:
During the date changing phase between 08.30 PM and 12 PM; the date must be set to the date of the following day.

03

Setting the date/time

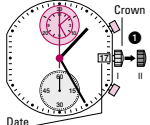

- Example:
- Date / time on the watch: [17] / 1:25 AM
- Present date / time: [4] / 8:30 PM
- 1 Pull out the crown to position II (the watch continues to run).
 - 2 Turn the crown anticlockwise until yesterday's date appears [3].
 - 3 * Pull out the crown to position III (the watch stops).
 - 4 Turn the crown until the correct date [4] appears.
 - 5 ** Continue to turn the crown until the correct time 8:30 PM appears.
 - 6 Push the crown back into position I.

Please note:
* To set your watch to the exact second, please refer to the chapter entitled «setting the time».
** Please observe the AM/PM clock rhythm.

04

Minute counter Hour counter

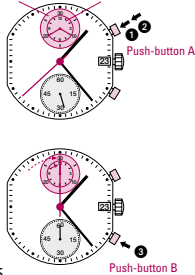

05

Chronograph: Basic function

(Start / Stop / Reset)

- Example:
- 1 Start: Press push-button A.
 - 2 Stop: to stop the timing, press pushbutton A once more and read the 3 chronograph counters:
4h / 20 min / 38 sec
 - 3 Zero positioning: Press push-button B. (The 3 chronograph hands will be reset to their zero positions).

Chronograph: Accumulated timing

- Example:
- 1 Start: (start timing)
 - 2 Stop: (e.g. 15 min 5 sec following 1)
 - 3 Restart: (timing is resumed)
 - 4 Stop: (e.g. 10 min 5 sec following 3)
= 25 min 10 sec
(The accumulated measured time is shown)
 - 5 Reset: The three chronograph hands are returned to their zero positions.

Please note:
* Following 4, the accumulation of the timing can be continued by pressing push-button A (Restart / Stop, Restart / Stop, ...)

06

Chronograph: Intermediate or interval timing

- Example:
- 1 Start: (start timing)
 - 2 Display interval: e.g. 10 minutes 10 seconds (timing continues in the background)
 - 3 Making up the measured time: (the 3 chronograph hands are quickly advanced to the ongoing measured time).
 - 4 Stop: (Final time is displayed)
 - 5 Reset: The 3 chronograph hands are returned to their zero position

Please note:
* Following 5, further intervals or intermediate times can be displayed by pressing push-button B (display interval / make up measured time, ...)

07

Adjusting the chronograph hands to zero position

- Example:
One or several chronograph hands are not in their correct zero positions and have to be adjusted (e.g. following a battery change).
- 1 Pull out the crown to position III (all 3 chronograph hands are in their correct or incorrect zero position).
 - 2 Keep push-buttons A and B depressed simultaneously for at least 2 seconds (the centre stop-second rotates by 360° → corrective mode is activated).

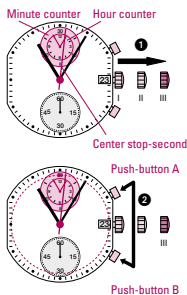

08

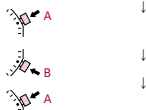

- Adjusting the centre stop second
- | | | |
|-------------|---|-----------|
| Single step | A | 1 x short |
| Continuous | A | long |
- Adjusting the next hand B
- | | | |
|-------------|---|-----------|
| Single step | A | 1 x short |
| Continuous | A | long |

- 3 Returning the crown to position I
Termination of the chronograph hands adjustment (can be carried out at any time).



Battery type: 384 (diameter 7.9 mm x 3.6 mm / SR 41 SW)
Accuracy: +20 / -10 seconds per month

RONDA is a supplier of watch movements including their operating instructions. Please refer to the watch retailer, service centre or manufacturer, should you have any questions regarding the watch. All relevant contact information can be found in your sales and/or guarantee documents.

