

CAL. VX3S, VX3T

RETROGRADE DAY INDICATOR

1/3

Instructions

Features

- ◆ Hour, Minute and Second Hands
- ◆ 3:00H: 31 day calendar display
- ◆ 6:00H: 24 hour display
- ◆ Retrograde Day Indicator
 - After the day hand reaches the last day of the week, the hand will jump to the first day of the week.

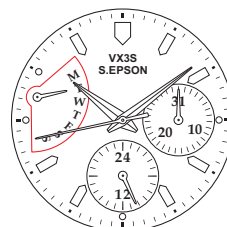

VX3S
9:30H: Retrograde day

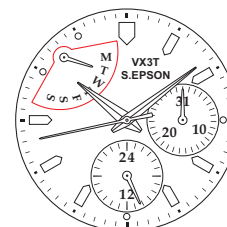

VX3T
10:30H: Retrograde day

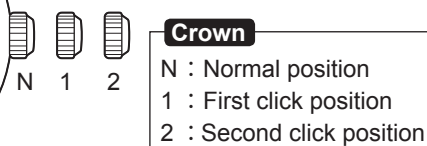
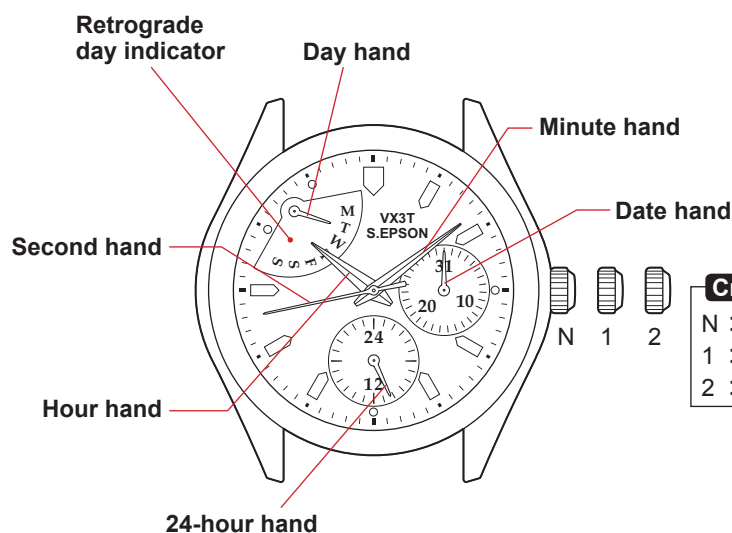
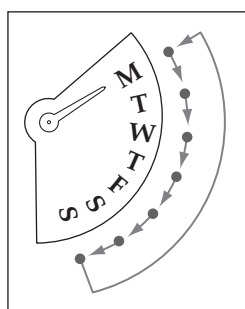

Movement Size	10 1/2"
Outside Diameter	24.00 mm: 21.50 mm (12H-6H) x 21.50 mm (3H-9H)
Casing Diameter	23.30 mm: 21.30 mm (12H-6H) x 21.50 mm (3H-9H)
Height	3.86 mm (Include battery)
Battery	SR920SW
Battery Life Approx.	3 years

- ◆ Timing of day changes
 - The date hand moves to the next between 11:00 p.m. and 12:00 p.m.
 - The day hand moves to the next between 2:00 a.m. and 4:00 a.m.



How to Set Time and Day of the Week:

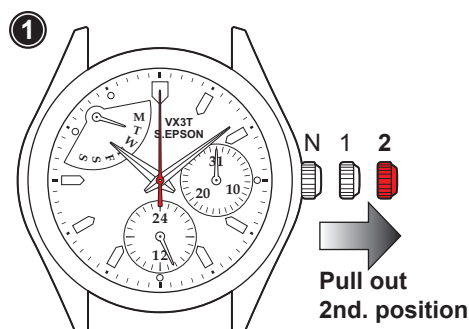

- Pull crown out to the 2nd click position when the second hand is at the 12 o'clock position.

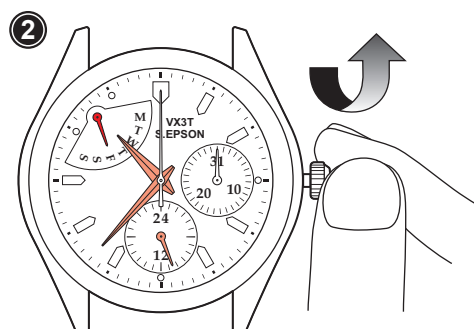

- Turn the crown clockwise to advance the hour and minute hands until Day hand is set to the desired day of the week.

Note: The day hand will not back by turning the crown counterclockwise.

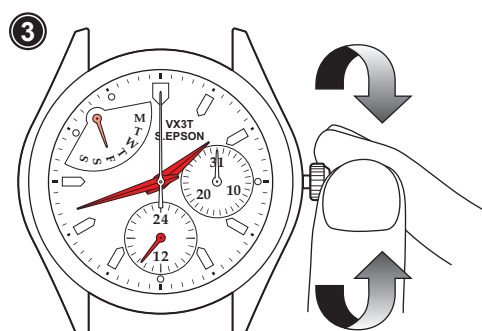

- Turn to set the time.

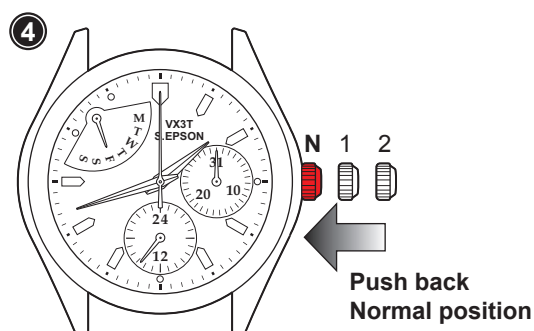

- Push crown back to normal position.

◆ Advanced Setting Techniques

- To advance the day hand quickly, turn back the hour and the minute hands 4 to 5 hours beyond the point of the day changes (between 11:00 p.m. and 4:00 a.m.), and then advance them again until the day hand is set to the next.

Note: The day hand will not move back by turning the crown counterclockwise.

- After the day hand reaches the last day of the week, turn the crown clockwise and the hand will return to the first day of the week (retrograde day indicator).
- The 24-hour hand moves correspondingly with the hour hand.
- When setting the hour hand, check that the 24-hour hand is correctly set.
- When setting the minute hand, advance it 4 to 5 minutes ahead of the desired time and then turn it back to the exact time.



S.EPSON Products

JAPAN TECHNOLOGY & QUALITY

www.timemodule.com

CAL. VX3S, VX3T

RETROGRADE DAY INDICATOR

3/3

Instructions

How to Set Date:

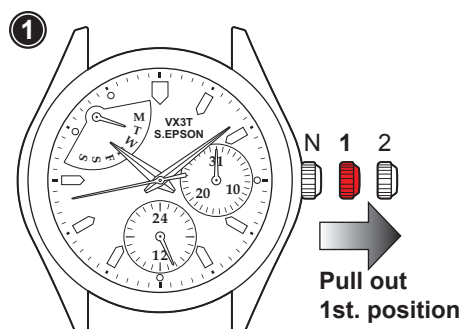

- Pull crown out to the 1st click position.



- Turn the crown counterclockwise to set Date hand.

Note: The date hand will not back by turning the crown clockwise.

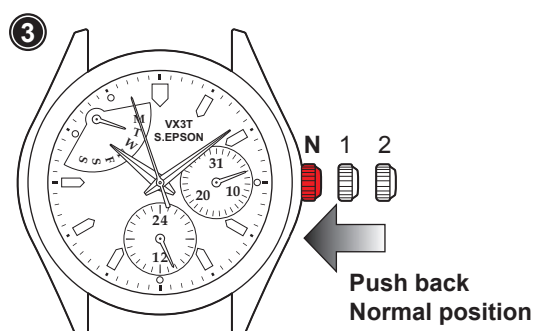

- Push crown back to normal position.

◆ Advanced Setting Techniques

- Do not set the date hand between 9:00 p.m. and 1:00 a.m. Otherwise, it may not turn properly.
- While setting the date hand, check that it moves properly in one-day increments.
- It is necessary to adjust the date on the first day after a 30-day month and February.



S.EPSON Products

JAPAN TECHNOLOGY & QUALITY

www.timemodule.com