

CAL.VS17

3 HANDS

1/4 Instructions

Features

- ◆ Hour, Minute and Second hands

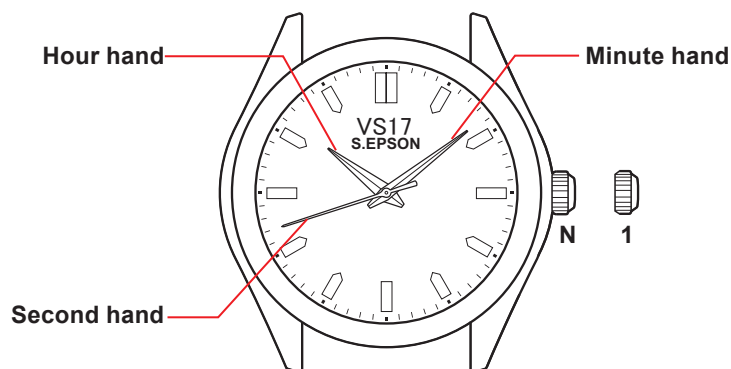

Crown

N: Normal position
1: First click position

Movement size	5 1/2"
Outside Diameter	ø12.05mm (3H-9H) x 15.55 mm (12H-6H)
Casing Diameter	ø11.80mm (3H-9H) x 15.55 mm (12H-6H)
Height	2.39 mm

How to charge and start the watch

◆ Charging the watch

- When you start the watch or when the energy remaining in the rechargeable battery is very low, charge it sufficiently by exposing the watch to light.

◆ Note

- It is not necessary to charge the watch fully. It is important, however, to charge the watch sufficiently, especially in the case of initial charging.

◆ Caution

Care in charging

- Make sure the watch temperature does not exceed 50°C while charging, to avoid damage to the parts inside.
- When charging the watch, do not place it too close to a hot light source such as a photoflash light, spotlight or incandescent light as this can greatly raise the watch temperature.
- When charging the watch by sunlight, do not leave it exposed to the sun for a long time, on the dashboard of a car, etc.. as this can greatly raise the watch temperature.



S.EPSON Products

JAPAN TECHNOLOGY & QUALITY

www.timemodule.com

Guidelines for charging time

(Dial transparency is 30%)

			Time required (approx.)		
Illumination (lux)	Source of light	Environment	A	B☆	C
700	Fluorescent lamp	Inside office	-	45 hours	115 minutes
3,000		30w 20 cm	85 hours	10 hours	28 minutes
10,000	Sunlight	Cloudy	25 hours	3 hours	8 minutes
100,000		Fine weather	4 hours	25 minutes	2 minutes

<Reference> The illuminance of 1,000 Lx is 70cm under from 30W fluorescent lamp.

Condition A: Time required for full charge

Condition B: Time required for steady operation

Condition C: Time required for 1 day's charge

☆ The values in this column represent the charging times required until the second hand moves constantly at 1-second intervals after the watch starts operating with the second hand moving at 2-second intervals.

Even if the watch is not charged for the time specified in the column, the second hand may temporarily move at 1-second intervals. But it will soon resume moving at 2-second intervals; therefore, charge the watch for more than the specified period.

The above table provides only general guidelines.

When the watch is fully charged, it will continue to operate for about 6 months.



CAL.VS17

3 HANDS

3/4 Instructions

How to set time

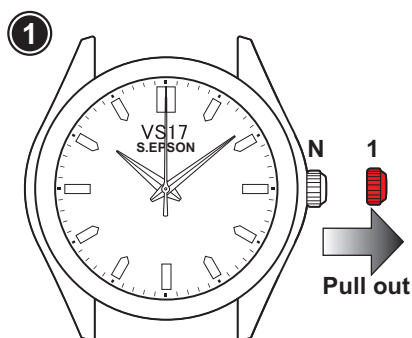

- Pull the crown out when the second hand is at the 12 o'clock position.

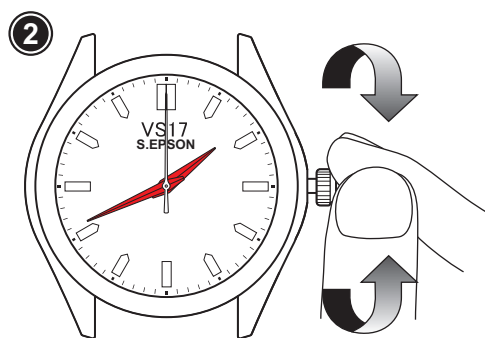

- Turn the crown to set the time.

Note: When setting the minute hand, advance it 4 to 5 minutes ahead of the desired time and then turn it back to the exact minute(s.)

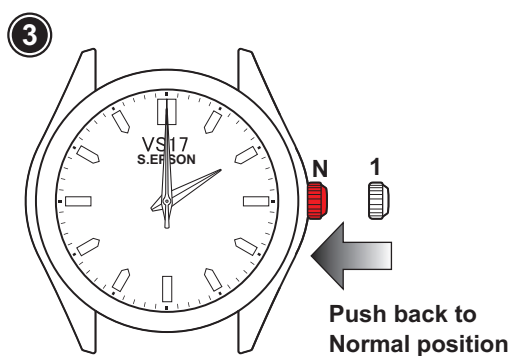

- Push the crown back to the normal position.
Confirm that the second hand begins to run.



S.EPSON Products
JAPAN TECHNOLOGY & QUALITY
www.timemodule.com

Note

◆ Energy depletion forewarning function

- When the energy stored in the rechargeable battery is reduced to an extremely low level, the second hand starts moving at 2-second intervals instead of the normal 1-second intervals.
- When this happens, recharge the watch as soon as possible by exposing it to light. Otherwise, the watch may stop operating within about 1 day.

◆ To prevent energy depletion

- Avoid covering the watch face with your clothing while wearing it.
- When the watch is not in use, leave it in a brightly lit place for as long as possible.
 - * Make sure that the watch temperature does not exceed 50°C.

◆ Notes on power supply

- This watch is provided with a rechargeable battery for exclusive use with the watch. Unlike with conventional battery-powered watches, therefore, battery replacement is not necessary.
- The solar cell is a clean energy source and has no adverse effect on the natural environment.

◆ Caution

- Never insert a conventional silver oxide battery in your watch as it may explode, generate intense heat or catch fire. The watch is designed not to operate if such a battery is installed in it.



S.EPSON Products

JAPAN TECHNOLOGY & QUALITY

www.timemodule.com