

# CAL.VS15

2 HANDS

# 1/5 Instructions

## Features

- ◆ Hour and Minute hands

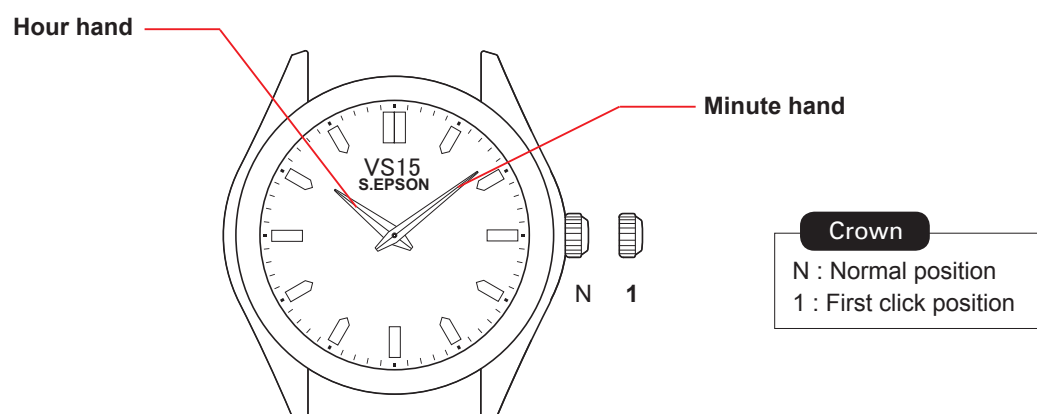

Movement size	5 1/2'''
Outside Diameter	11.80mm (3-9H) x 15.55 mm(12-6H)
Casing Diameter	11.80mm (3-9H) x 15.15 mm(12-6H)
Height	2.09 mm



**S.EPSON Products**  
JAPAN TECHNOLOGY & QUALITY  
[www.timemodule.com](http://www.timemodule.com)

### How to charge and start the watch

#### ◆ Charging the watch

- When you start the watch or when the energy remaining in the rechargeable battery is very low, charge it sufficiently by exposing the watch to light.

#### ◆ Note

- It is not necessary to charge the watch fully. It is important, however, to charge the watch sufficiently, especially in the case of initial charging.

#### ◆ Caution

Caution care in charging

- When charging the watch, do not place it too close to a hot light source such as a photoflash light, spotlight or incandescent light as this can greatly raise the watch temperature.
- When charging the watch by sunlight, do not leave it exposed to the sun for a long time, on the dashboard of a car, etc.. as this can greatly raise the watch temperature.
- Make sure the watch temperature does not exceed 50°C while charging, to avoid damage to the parts inside.



**S.EPSON Products**

JAPAN TECHNOLOGY & QUALITY

[www.timemodule.com](http://www.timemodule.com)

# CAL.VS15

2 HANDS

## 3/5 Instructions

### Guidelines for charging time

(Dial transparency is 30%)

			Time required (approx.)		
Illumination (lux)	Light source	Environment	A (Hours)	B (Hours)	C (Minutes)
700	Fluorescent lamp	Inside office	-	40	50
3,000		30w 20 cm	40	10	11
10,000	Sunlight	Cloudy	12	4	3
100,000		Fine weather	2	0.5	1

<Reference> The illuminance of 1,000 Lx is 70cm under from 30W fluorescent lamp.

Condition A: Time required for full charge

Condition B: Time required for steady operation

Condition C: Time required for 1 day's charge

The above table provides only general guidelines.

When the watch is fully charged, it will continue to operate for about 6 months.



**S.EPSON Products**

JAPAN TECHNOLOGY & QUALITY

[www.timemodule.com](http://www.timemodule.com)

# CAL.VS15

2 HANDS

## 4/5 Instructions

### How to set time

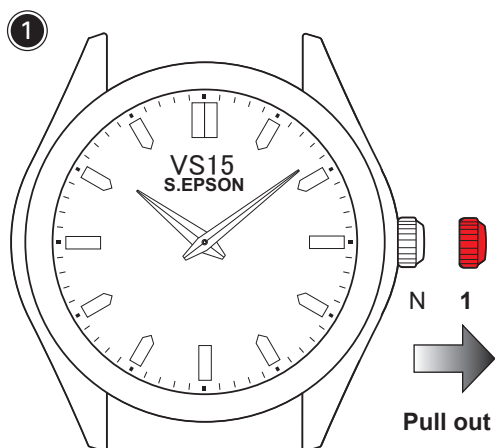

- Turn the crown to set the time.

*Note: When setting the minute hand, advance it 4 to 5 minutes ahead of the desired time and then turn it back to the exact time.*

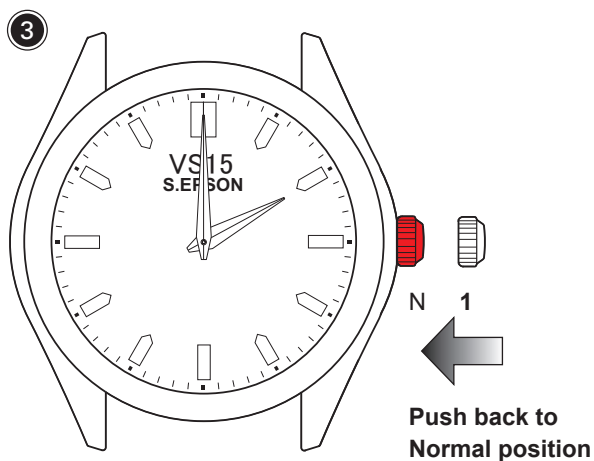

**S.EPSON Products**

JAPAN TECHNOLOGY & QUALITY

[www.timemodule.com](http://www.timemodule.com)

# CAL.VS15

2 HANDS

5/5  
Instructions

## Note

### ◆ To prevent energy depletion

- Avoid covering the watch face with your clothing while wearing it.
- When the watch is not in use, leave it in a brightly lit place for as long as possible.
  - \* Make sure that the watch temperature does not exceed 50°C.

### ◆ Note on power supply

- This watch is provided with a rechargeable battery for exclusive use with the watch. Unlike with conventional battery-powered watches, therefore, battery replacement is not necessary.
- The solar cell is a clean energy source and has no adverse effect on the natural environment.

### ◆ Caution

- Never insert a conventional silver oxide battery in your watch as it may explode, generate intense heat or catch fire. The watch is so designed that even if such a battery is installed it will not operate.



**S.EPSON Products**

JAPAN TECHNOLOGY & QUALITY

[www.timemodule.com](http://www.timemodule.com)