

Catalog No. 63-1~63-2

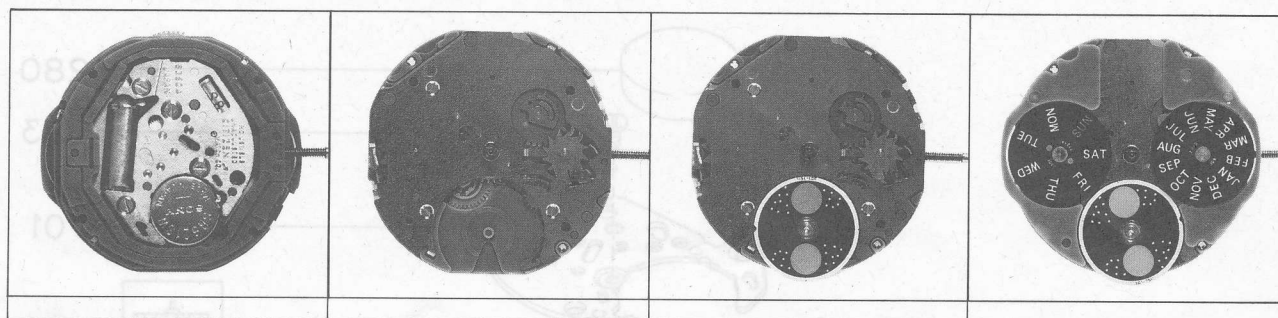

63-1
(Catalog No.)

63-2
(Catalog No.)

63-2
(Catalog No.)

63-2
(Catalog No.)

6355A

- Analog quartz watch (Center hand + 2 small hands)
- Date indication (Center hand)
- Day, Month indication (Small hand)
- Second hand stopping device
- Power saving switch

Thickness: 3.4mm

Size: $\phi 23.3 \times 22.6\text{mm}$

6300A

- Analog quartz watch (3 small hands)
- Date indication (Small hand)
- Day indication (Small hand)
- Month indication (Small hand)
- Age of the moon
- Second hand stopping device
- Power saving switch

Thickness: 3.4mm

6350A

- Analog quartz watch (Center hand + 2 small hands)
- Date indication (Center hand)
- Day, Month indication (Small hand)
- Age of the moon
- Second hand stopping device
- Power saving switch

Thickness: 3.5mm

Size: $\phi 23.3 \times 22.6\text{mm}$

6380A

- Analog quartz watch (Center hand)
- Date indication (Center hand)
- Day, Month indication (Window)
- Age of the moon
- Second hand stopping device
- Power saving switch

Thickness: 3.8mm

Size: $\phi 23.3 \times 22.6\text{mm}$

Oscillation per second

32,768Hz

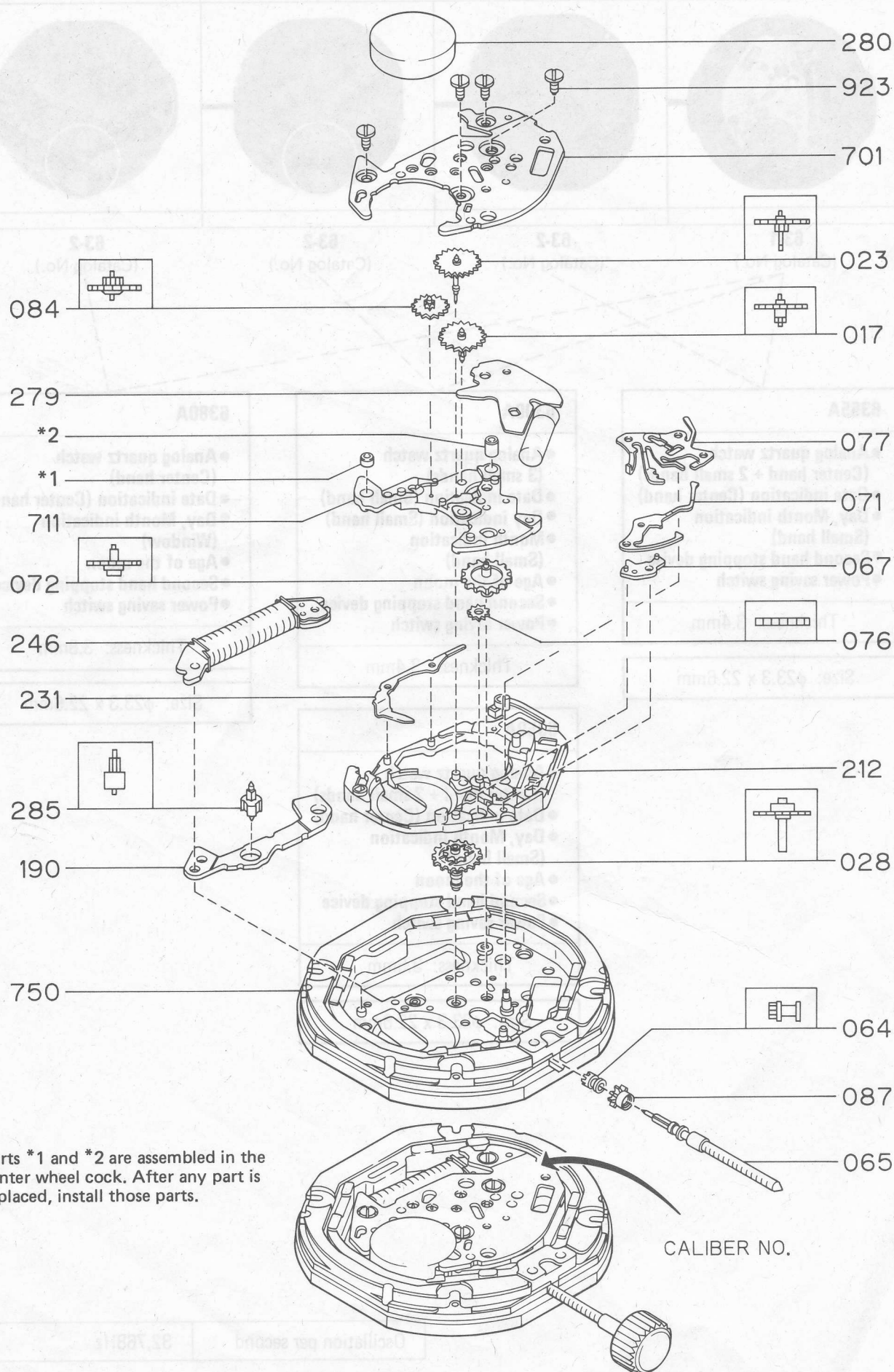

Catalog No. 63-1

Part No.	Name of parts	Caliber No.		6300A	6350A	6355A	6380A							
		Nos. of jewels												
			00											
701	Train wheel bridge	732		687		665	693							
711	Center wheel cock	131	—○—			—○—	—○—							
017	Third wheel and pinion	119	—○—			—○—	—○—							
023	Fourth wheel and pinion	205		224	—○—		225							
028	Cannon pinion with driving wheel	113		137	—○—		142							
064	Clutch wheel	79	—○—			—○—	—○—							
065	Setting stem	379	—○—			—○—	—○—							
065	Switching stem													
067	Setting lever	173	—○—			—○—	—○—							
071	Yoke	97	—○—			—○—	—○—							
072	Minute wheel and pinion	89	—○—			—○—	—○—							
076	Setting wheel	64	—○—			—○—	—○—							
077	Setting lever spring	109	—○—			—○—	—○—							
084	Fifth wheel and pinion	46	—○—			—○—	—○—							
087	Intermediate unlocking corrector wheel													
087	Intermediate date corrector wheel	62	—○—			—○—	—○—							
087	Intermediate second wheel (I)													
190	Stator	79	—○—			—○—	—○—							
212	Spacer for setting stem	149	—○—			—○—	—○—							
227	Alarm switch spring													
231	Power cell connector spring	163	—○—			—○—	—○—							
233	Switch insulator													
234	Power cell strap													
246	Coil unit	121	—○—			—○—	—○—							
267	Switch click stop spring													
279	Unit of electronic circuit	545	—○—			—○—	—○—							
279	Electronic circuit for alarm													
280	Power cell	34	—○—			—○—	—○—							
285	Rotor	80	—○—			—○—	—○—							
903	Friction spring for second wheel													
903	Alarm contact spring													
922	Screw for power cell strap													
922	Screw for date dial guard													
923	Screw for train wheel bridge	81	—○—			—○—	—○—							
938	Screw for case clamp	56	—○—			—○—	—○—							
750	Metal plate	999	—○—			—○—	A120							

Catalog No. 63-2

Cal. 6300

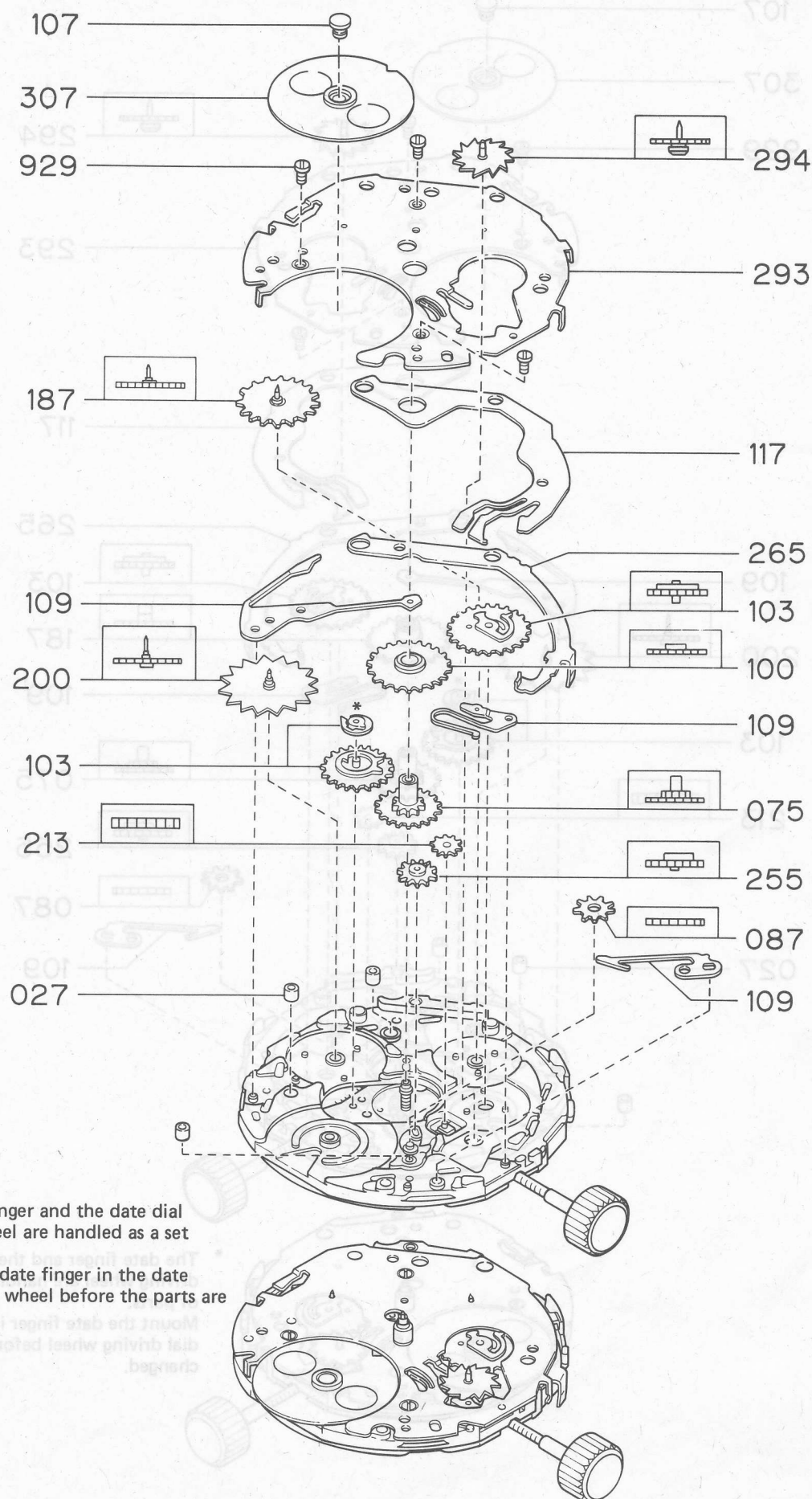

* The date finger and the date dial driving wheel are handled as a set of parts. Mount the date finger in the date dial driving wheel before the parts are changed.

Catalog No. 63-2

Cal. 6355

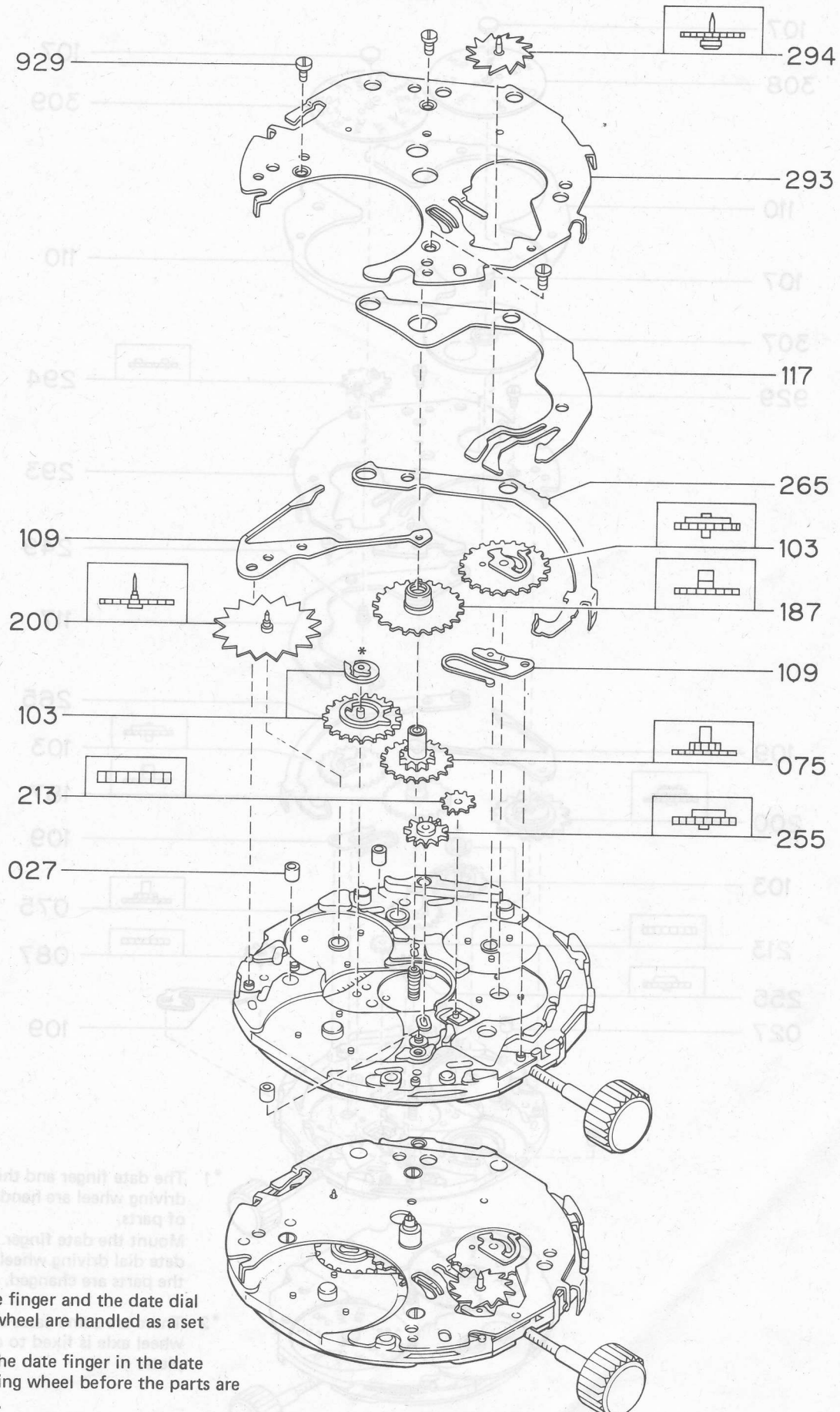

* The date finger and the date dial driving wheel are handled as a set of parts. Mount the date finger in the date dial driving wheel before the parts are changed.

Cal. 6380

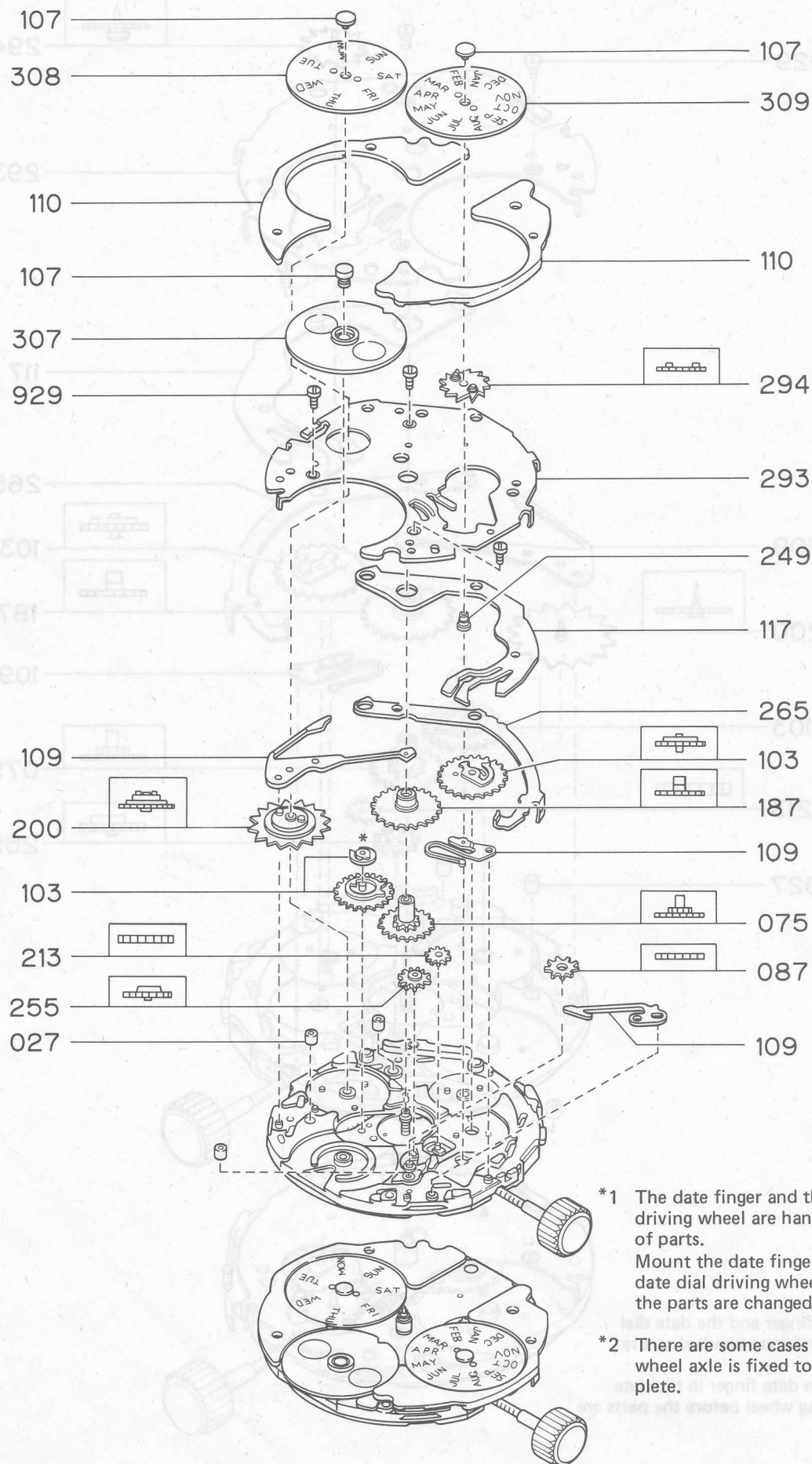

Catalog No. 63-2

Part No.	Name of parts	Caliber No.																	
		Nos. of jewels		6300A	6350A	6355A	6380A												
				00	00	00	00												
713	Date dial guard																		
025	Second wheel																		
027	Dial guard gib			102	—○—○—○														
075	Hour wheel			328	306	—○	312												
078	Dial washer																		
087	Intermediate second wheel (II)																		
087	Intermediate second wheel (III)																		
087	Intermediate second wheel (IV)																		
087	Intermediate moon age corrector			79	—○		79												
100	Intermediate date wheel			33															
103	Date dial driving wheel			97	—○—○—○														
103	Month dial driving wheel			95	—○—○—○														
107	Stud pin for moon age plate			302	—○		303												
107	Stud pin for month dial						301												
107	Stud pin for day dial						○												
109	Date jumper			52	—○—○—○														
109	Month jumper			53	—○—○		55												
109	Moon age jumper			54	—○		54												
110	Dial guard ring																		
110	Dial spacer (I)						26												
110	Dial spacer (II)						27												
116	Calendar corrector lever																		
117	Month correcting lever guard			26	—○—○—○														
169	Unlocking wheel																		
171	Unlocking wheel supporter																		
178	Day dial gib																		
178	Moon plate gib																		
184	Connector for unlocking wheel																		
184	Connector for electronic circuit																		
187	Date wheel			06	03	—○	04												
200	Day wheel			03	—○—○		04												
213	Unlocking corrector wheel																		
213	Calendar corrector wheel			33	—○—○—○														
249	Month wheel axle						57												
255	Calendar correcting pillar wheel			34	—○—○—○														
265	Month correcting lever			14	—○—○—○														
293	Date dial guard																		
293	Dial guard			87	—○—○—○		89												
294	Month wheel			59	—○—○		60												
922	Screw for date dial guard																		
929	Screw for date dial guard																		
929	Screw for dial guard			52	—○—○—○														
934	Screw for unlockng wheel suppoter																		